

TECHNICAL DATA SHEET
Ref. 500008
 UNIPOLAR STAINLESS STEEL
 BATTERY MASTER SWITCH
 24VDC / 150A



GENERAL CHARACTERISTICS

Protection degree: IP63
 Ambient temperature: -40°C to +85°C
 Weight: 0.264 Kg approx.
 Contacts: Copper
 Connections: not polarized

FIELDS OF APPLICATION

Handling vehicles, industrial vehicles,
 agriculture machinery, industry...

POWER CIRCUIT

Connection: M10 terminals
 Tightening torque: 1.5 +/- 0.1 daN·m
 Type: D1 normally open
 Nominal current: 150 A
 Nominal voltage: 24 VDC
 Max. capacity: 1000 A during 5 seconds

PARTICULAR CHARACTERISTICS:

Stainless steel
 Removable handle with PVC protector

SPARE PARTS

Handle + chain + protector	520024
Handle	520002
Strap + PVC protection	520004

Size diagrams

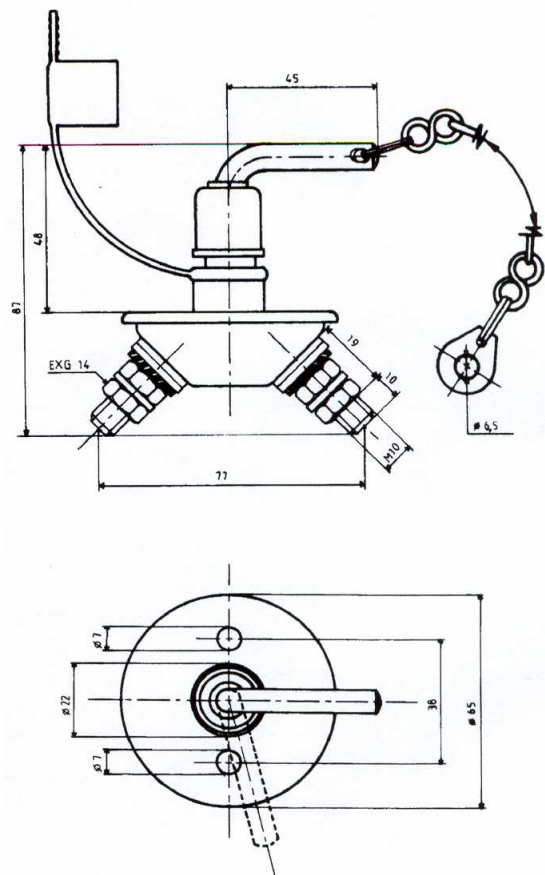

Connection diagram

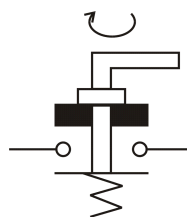

Fixing diagram

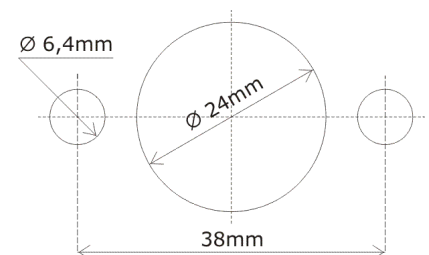

P.I. El Raiquer, C/ El Raiquer, s/n, NAVE Nº21-22
 08170 MONTORNÈS DEL VALLÈS
 BARCELONA (SPAIN)
 Tel. : + 34.93.544.44.80 - Fax : + 34.93.544.44.90
www.cormar.es - info@cormar.es